



Cherry Cottage, 28 Buttefield Close, Netherhampton, Salisbury, Wiltshire, SP2 8PU

£1,150 PCM

A recently constructed two-bedroom single-story house located on the high-end Netherhampton development. The accommodation has been finished to a high standard with two double bedrooms, an en-suite shower room and separate bathroom, a light and airy kitchen/living dining room with bi-fold doors to the garden, utility room and a spacious hall. More sustainable heating is provided via the latest generation of air source heat pump. Outside, there is an area of garden accessed from the kitchen with bi-fold doors and having a patio area and artificial grass offers low maintenance. Parking within communal car barn opposite the house. The property has new carpets and/or wood effect floors but otherwise is unfurnished. Minimum one-year term with the potential for a long-term tenancy, NO PETS

The nearby town of Wilton has a range of amenities including a small supermarket, bakery, a doctor, dentist, cafes, pubs, a hotel with restaurant and a weekly market. Additionally, the Cathedral city of Salisbury is located 3.5 miles away.

The property is available from the end of June/ early July

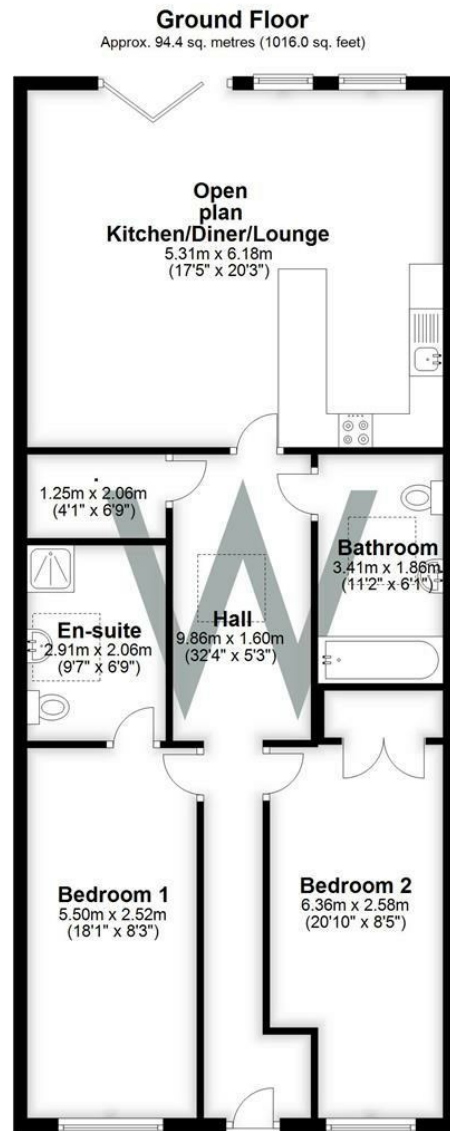

Total area: approx. 94.4 sq. metres (1016.0 sq. feet)



Energy Efficiency Rating		Current	Potential
Very energy efficient - lower running costs			
(92 plus) A			97
(81-91) B		86	
(69-80) C			
(55-68) D			
(39-54) E			
(21-38) F			
(1-20) G			
Not energy efficient - higher running costs			
England & Wales		EU Directive 2002/91/EC	

WHITES
Castle Chambers, 47 Castle Street,
Salisbury, Wiltshire, SP1 3SP
01722 336422
www.hwwhite.co.uk
residential-sales@hwwhite.co.uk

